



**WM. W MEYER & SONS, INC.**  
**SKOKIE, IL**

# **OPERATION AND MAINTENANCE MANUAL**

**MEYER PORTAVAC**

291-A-001  
REV. A

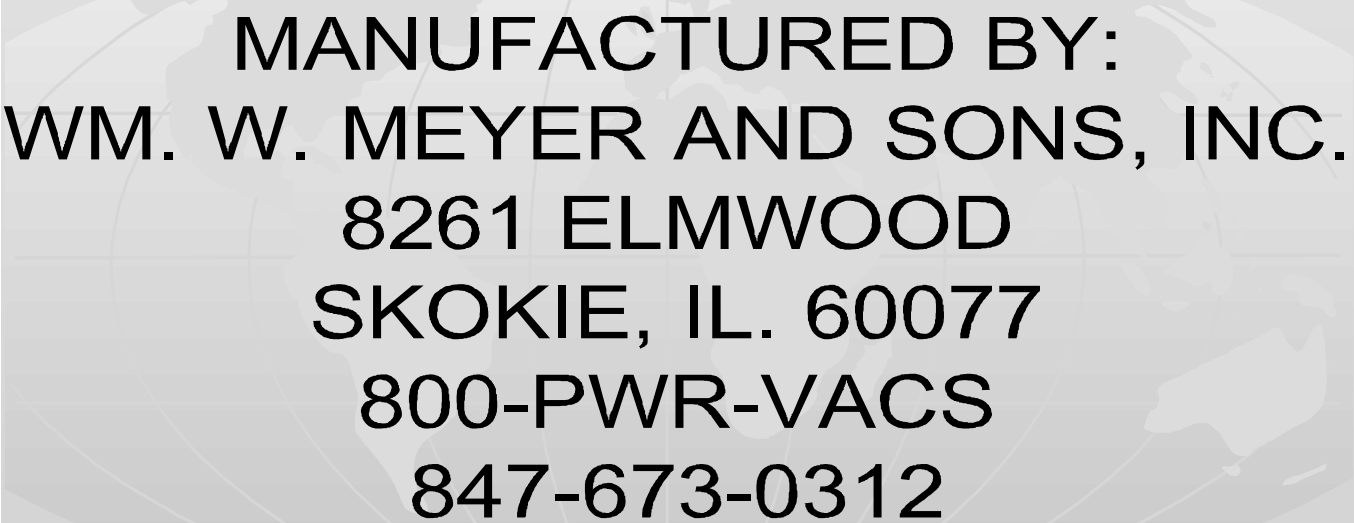

**MANUFACTURED BY:  
WM. W. MEYER AND SONS, INC.  
8261 ELMWOOD  
SKOKIE, IL. 60077  
800-PWR-VACS  
847-673-0312**

## TABLE OF CONTENTS

SECTION	DESCRIPTION
1	WARRANTY / QUALITY ASSURANCE
2	SAFETY
3	SPECIFICATIONS
4	PRE-START CHECKLIST
5	STARTING PROCEDURES
6	SHUT DOWN PROCEDURES
7	PARTS LIST / MAINTENANCE
8	TROUBLESHOOTING

**SECTION 1**  
**WARRANTY / QUALITY**  
**ASSURANCE**

# **SECTION 2**

# **SAFETY**

## **SECTION 2: SAFETY**

### **2-1 GENERAL**

Safety is proudly built into every product manufactured by Wm. W. Meyer and Sons, Inc. Carelessness and / or negligence are the usual causes for personnel injury and equipment failure. Safety is very important to everyone so we insist that all operators read and understand this manual.

- 1) Equipment is to be operated by trained qualified personnel only.
- 2) Always read and follow the operating and safety procedures.
- 3) Do not operate without all guards and safety equipment installed in the proper location and in working order.
- 4) Do not disable any safety features. They are there for your protection.
- 5) Always use qualified personnel when repairing or maintaining the equipment.
- 6) This equipment must be used only for the purpose for which it was intended. Any other use will void the warranty and could cause bodily injury to the operator and costly damage to the equipment.
- 7) If a malfunction should occur, turn the machine off immediately and correct the problem, before restarting the machine.
- 8) Do not leave the equipment unattended while it is running.
- 9) Do not wear loose clothing or jewelry when operating this equipment. Long hair should be confined by a hat or a hair net.
- 10) Do not operate under the influence of alcohol or drugs.

### **2-2 DUCT CLEANING SAFETY**

- 1) Limit the operation only to those personnel trained in the proper use and operation of the machinery.
- 2) Never operate the machine without proper ventilation.
- 3) Keep all clothing and your body away from the rotating equipment.
- 4) Obey all safety labels and instructions affixed to the machine.
- 5) Never run the machine speed faster than the factory settings.

If there are any questions as to the safe operation of this equipment, please do not hesitate to contact us at 1-800-797-8227

# **SECTION 3 SPECIFICATIONS**

## SECTION 3: SPECIFICATIONS

### 3-1 PURPOSE

The Meyer **Portavac** is designed to safely and easily clean heating and cooling ducts. We recommend the owner / operator contact and become a member of the **NATIONAL AIR DUCT CLEANERS ASSOCIATION**. (202) 737-2926. Contact them if you have any questions concerning the proper approved mechanical cleaning methods.

Your **Portavac** is usually sold as a package with a compressor and the proper duct cleaning accessories to do an effective job. If your **Portavac** was not purchased as a system then you must have the following item to start cleaning ducts.

- A) Hose inlet adapter (if 10" hose is not used)
- B) 8" or 10" hose
- C) When using more than one length of hose then you must use a hose connector.
- D) 8" or 10" duct collar (depending on the hose size)
- E) Air Compressor
- F) Duct Ball System
- G) Manual or Rotary Brushes
- H) Hole Saws
- I) Patches
- J) Sheet Metal Screws

If you do not have the cleaning accessories listed above call Wm. W. Meyer and Sons for assistance.

# **SECTION 4**

## **PRE START-UP CHECKLIST**

## SECTION 4: PRE START-UP CHECKLIST

### 4-1 RECEIVING YOUR **PORTAVAC**

Immediately check the condition of your new **Portavac** as received. The machine was shipped in perfect condition and should arrive the same way. If there are any visible problems, mark them on the Bill Of Lading that the carrier has and call his office immediately before the driver leaves your premises. As sympathetic as we are to any damages or shortages that occur in shipping Wm. Meyer and Sons has no legal recourse for such claims. Title to your machine was transferred to the carrier as soon as it left or dock. However, please let us know by phone and writing about any problems so that we can assist you with immediate replacement parts or information.

### 4-2 UNCRATING

Carefully remove all of the packing materials and check the parts against the Packing List. Your **Portavac** was test-run and shipped with all fluids at the proper levels. Check them now and top off as required. Fill the gas tank. Your new **Portavac** is now ready for operation.

# **SECTION 5**

## **START-UP**

## SECTION 5: START-UP



AT ALL TIMES KEEP YOUR HANDS, CLOTHING, ETC. AWAY FROM THE INLET AND DISCHARGE OF YOUR **PORTAVAC**.

# **SECTION 6 SHUT DOWN**

## SECTION 6: SHUT DOWN

- 1) Move the throttle to the slow position. Run the machine for approx. 5 minutes.
- 2) Turn the engine off
- 3) Remove the bag.
- 4) Disconnect the hose



CAUTION! Do not remove the hose or the bag until the **Portovac** has come to a complete stop.

**SECTION 7**  
**PARTS LIST / MAINTENANCE**

## SECTION 7: PARTS LIST

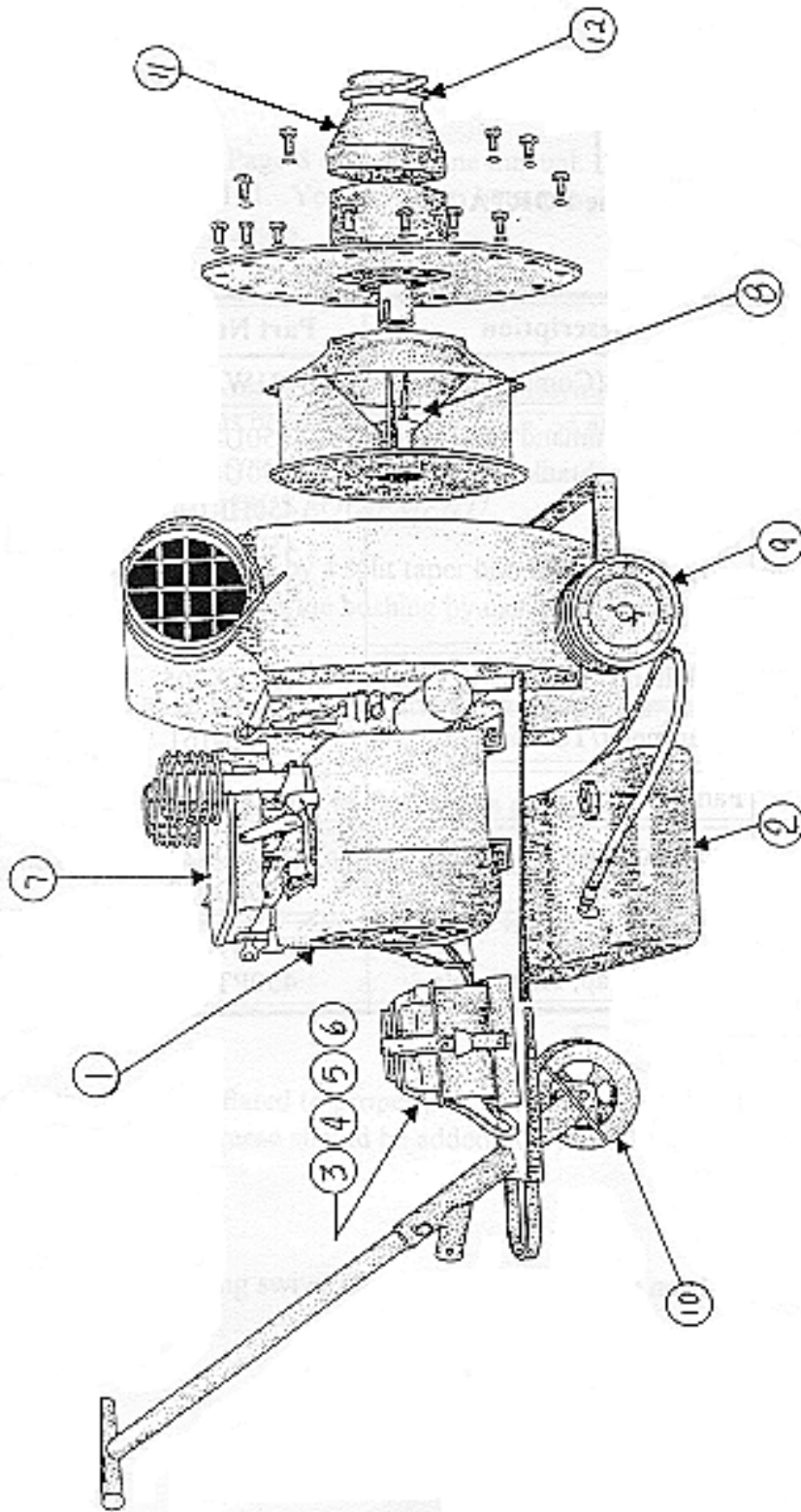

ITEM	PART NUMBER	DESCRIPTION	QTY
	421WA043	PORTA VAC ASSEMBLY	1
1	450U-159	20 HP ENGINE	1
2	450U-087	FUEL TANK	2
3	450HK030	12V BATTERY	1
4	450HK028	RED BATTERY CABLE	1
5	450HK029	BLACK BATTERY CABLE	1
6	450HK031	BATTERY CASE	1
7	421WA042	FAN WHEEL	1
8	450JD024	8" PNEUMATIC WHEEL	2
9	450JD028	8" SWIVEL CASTER	1
10	450PT051	ADJUSTABLE STRAP CLAMP	2
11	421WA007	8" X 10" INLET REDUCER	1
12	450XX205	OIL FILTER WRENCH	1
13	450GD098	TACHOMETER / HOURMETER	1

## 7-2 MAINTENANCE

- 1) ENGINE: Refer to the attached service manual for the engine servicing.
- 2) BATTERY: The battery provided with your equipment is of the lead acid type. The battery cables should be checked daily for corrosion and tightness.
- 3) FAN HOUSING AND WHEEL: During the normal use of your **Portavac**, no maintenance is required on the fan wheel or housing.

If a problem, noise, or vibration should occur stop the equipment immediately!!. Contact the factory as soon as possible. Do not operate this equipment until it has been thoroughly checked by the factory or factory authorized representative.



The fan wheel assembly has been balanced at the factory. Noises or vibrations coming from the fan means that for some reason the fan wheel has become out of balance. The assembly is rotating at 3600 rpm. In an out of balance situation the possibility of the wheel exploding in the housing is extremely great if allowed to continue. ***The possibility of injury or death to the operator or any bystanders is very real.***

Do not replace the factory fan with any other fan other than the factory approved replacement.

# **SECTION 8 TROUBLESHOOTING**

## **SECTION 8: TROUBLESHOOTING**

ENGINE: Refer to attached owners manual for engine servicing and troubleshooting

NO SUCTION FROM THE END OF THE HOSE:

- 1) Stop engine
- 2) Check hoses for blockage or loose connections
- 3) Check fan inlet for blockage
- 4) Check discharge for blockage
- 5) Inspect fan interior for blockage